

Servitite®

A range of high performance, internal PVC waterstops for passive protection of critical joints in reinforced concrete structures.

Advantages

- **Robust profile** - large solid circular end bulbs promote better anchorage and embedment into concrete and simplifies site jointing.
- **Flexible** - will accommodate large movements during construction and service life.
- **Pliable** - remains flexible at low temperatures.
- **Valve action** - created by concrete shrinkage around end bulbs and adjacent fin formation.
- **Thick web** - 10mm thickness prevents folding over and displacement during concrete pouring.
- **Common section for easy installation** - for construction and expansion joints subject to thermal movement and deflection.
- **UK WRAS listed** - Servitite® is approved for potable water.

Applications

Servitite is an internally cast specially formulated PVC waterstop system manufactured in a range of sizes for use in reinforced concrete structures. Being cast into the centre of the concrete member, Servitite® waterstops will provide resistance against high hydrostatic pressure from both faces.

It is essential to form a continuous waterstop network at all joints to prevent the ingress or escape of moisture/water. For changes of direction or profile only factory produced fabrications should be used with site jointing limited to simple butt welds.

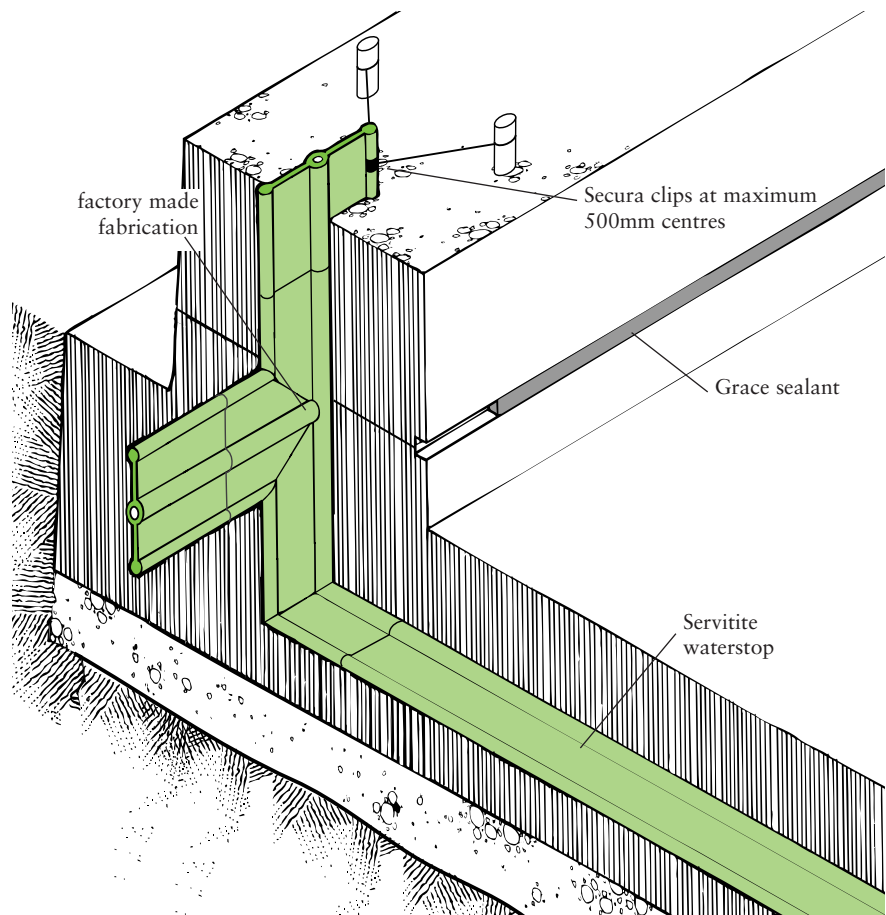

Supply

Normal construction/movement joints

Servitite® 150	7.5 m rolls wt 20.5 kg
Servitite® 230	5.0 m rolls wt 24.7 kg
Servitite® 305	5.0 m rolls wt 27.2 kg

Factory made junctions and fabrications Available in sizes and configurations to suit the site requirements.

Ancillary Products

Secura Clip Small (20mm)	Unit for Servitite® 150
Secura Clip Large (25mm)	Unit for Servitite® 230 and 305

Equipment by Serviced®

Joining Jig

Jig Servitite® 150/230/305

Welding Knives

Electric Knife 110v

Wall Joints

Servitite must be supported in split-end form work as described for slab joints, with great care taken to ensure that the waterstop does not fold over under the weight of poured concrete. The waterstop may be securely wired to the reinforcing steel using the appropriate Secura Clips supplied, clipped over the end bulbs as shown below.

A fully continuous waterstop network must be formed using only factory made junctions with site joints limited to simple butt welds of similar section.

Size of Waterstop	Minimum Concrete Section
Servitite 150	170 mm
Servitite 230	255 mm
Servitite 305	330 mm

Note: The above information assumes that waterstops are installed centrally in a joint.

Equipment by Others

Fine tooth saw, wire brush, Stanley knife, 110v or 220v power source.

Physical Properties

Servitite

Tensile Strength	15.0 N/mm ²
Elongation at break	310%
B.S. Softness	42
Specific Gravity	1.42

Compound Tested in accordance with BS2571 and are typical values. Servitite is UK WBS approved.

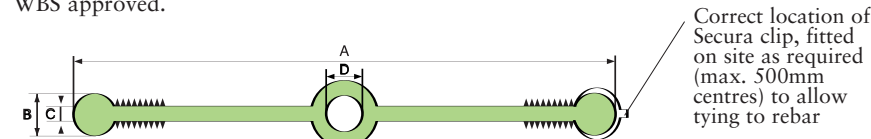

Size	NOMINAL Dimensions				Secura clip size
	A	B	C	D	
150	150mm	19mm	10mm	13mm	20 mm
230	230mm	25mm	10mm	20mm	25 mm
305	305mm	25mm	10mm	20mm	25 mm

Health And Safety

There is no legal requirement for a Material Safety Data Sheet for Servitite, Secura Clips Korkpak or Aerofil. For health and safety questions on these products please contact Grace Construction Products Limited.

Irritating fumes (Hydrogen Chloride) will be liberated when the product is heat welded. Ensure adequate ventilation.

For Grace Sealants read the product label and Material Safety Data Sheets (MSDS's) before use. Users must comply with all risk and safety phrases. MSDS's can be obtained from Grace Construction Products or from our web site at www.graceconstruction.com.

NBS Specification Clause

Refer to Clause E40 310.

Installation

Slab joints

Servitite should be supported in specially prepared split stop-end formwork which holds the waterstop in the horizontal plane so preventing displacement and folding so that half of its width will be cast into the concrete approximately half way through the thickness of the slab.

Care must be taken to ensure that the waterstop is retained in the horizontal plane and that adequate compaction of

concrete takes place below the web of the waterstop in order to avoid "honeycombing". Lifting the waterstop during compaction to release entrapped air will assist in forming dense compacted concrete.

After stripping the formwork supporting the waterstop, the second half can be cast into the adjoining slab with similar precautions taken with regard to "honeycombing".

Details shown are typical illustrations only and not working drawings. For assistance with working drawings and additional technical advice please contact Grace Technical Services

 Visit our web site at www.graceconstruction.com

Grace Construction Products Ltd, Ajax Avenue, Slough, Berkshire SL1 4BH United Kingdom Tel +44 (0)1753 692929 Fax +44 (0)1753 691623

Adcor, Aerofil, BETEC, Bituthene, Hydproduct, Insupak, Korkpak, Paraflex, Paraseal, Preprufe, Procor, Serviced, Servidek, Servigard, Servijoint, Servimastic, Servipak, Servirufe, Serviseal, Servistrip, Servitite, Vertigard and Vertiseal are registered trademarks of W R Grace & Co.-Conn.
Adprufe, Armourtape, Bitushield, Bitustik, Bitutape, Hydropaste, Pak Adhesive, PVC Edgetie, Serviband, Serviflex, Servitape, Slipstrip, and Solarshield are trademarks of W R Grace & Co.-Conn.

The information given is based on data and knowledge considered to be true and accurate and is offered for the user's consideration, investigation and verification. Since the conditions of use are beyond our control we do not warrant the results to be obtained. Please read all statements, recommendations or suggestions in conjunction with our conditions of sale including those limiting warranties and remedies which apply to all goods supplied by us. No statement, recommendation or suggestion is intended for any use which would violate or infringe statutory obligations or any rights belonging to a third party.

Copyright 2006. Grace Construction Products Limited.

Printed in England - 05.06- Ref. W004C

GRACE
Construction Products